

20th April, 2021

Mr Jerry Barnes
Director
MacCabe Durney Barnes Ltd
20 Fitzwilliam Place
Dublin 2

WITHOUT PREJUDICE
SUBJECT TO CONTRACT/CONTRACT DENIED

Dear Mr. Barnes

Re: Proposed Grant of Consent to include lands in the charge/control of the Council in a planning application to An Bord Pleanála to facilitate pedestrian, cycle and vehicular access to proposed Strategic Housing Development in Stocking Lane, Dublin 16

I refer to your request to include lands in the charge/control of the Council in a proposed planning application.

I now wish to confirm that South Dublin County Council hereby grants its consent to include lands coloured blue on attached Indicative Drawing No. PR402491-ACM-01-00-DR-CE-00-0002 in a planning application for the purposes outlined above.

Please note that this consent does not convey to MacCabe Durney Barnes Ltd. any interest whatsoever in the subject lands and is for the sole purpose of allowing a planning application to be made.

This consent is valid for a period of twelve months from date of this letter.

Yours sincerely



PP Tony O'Grady
Senior Engineer
Road Maintenance Section

Encl 1

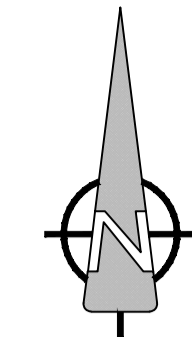
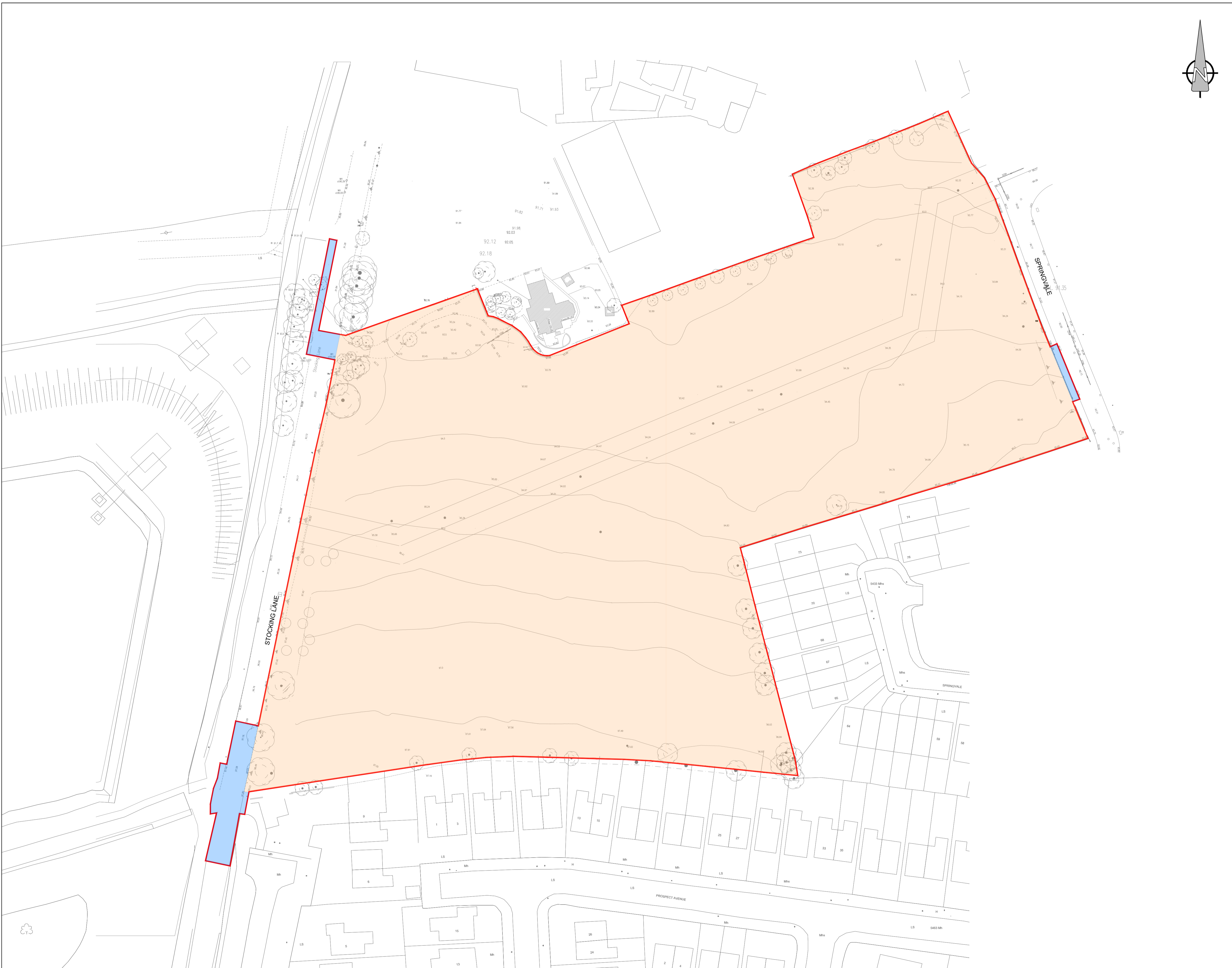

PROJECT
 PROPOSED STRATEGIC HOUSING DEVELOPMENT AT STOCKING LANE, BALLYBODEN, DUBLIN 16

CLIENT
 MacCABE DURNEY BARNES

CONSULTANT
 AECOM
 4th Floor Adelphi Plaza,
 George's Street Upper,
 Dun Laoghaire,
 Co Dublin
 Tel: +353 (0)1 2383100
 Fax: +353(0)1 2383199
 www.aecom.com

- NOTES**
- THIS DRAWING IS TO BE READ IN CONJUNCTION WITH ALL OTHER RELEVANT ARCHITECTURAL AND ENGINEERING DRAWINGS. ANY DISCREPANCIES, ERRORS OR OMISSIONS TO BE BROUGHT TO THE ATTENTION OF THE DESIGNER.
 - ALL DIMENSIONS TO BE CHECKED BY THE CONTRACTOR ON SITE PRIOR TO COMMENCEMENT OF WORKS.
 - AECOM LIMITED TO BE INFORMED BY THE CONTRACTOR OF ANY DISCREPANCIES PRIOR TO THE COMMENCEMENT OF WORKS ON SITE.
 - DIMENSIONS OF ALL BOUNDARIES AND ADJOINING ROADS TO BE CHECKED ON SITE PRIOR TO COMMENCEMENT OF WORKS.

LEGEND

SDCC CONTROLLED, AS PER TAKEN IN CHARGE DRAWING ■

APPLICANT LAND ■

This drawing has been prepared for the use of AECOM's client. It may not be used, modified, reproduced or relied upon by third parties, except as agreed by AECOM or as required by law. AECOM accepts no responsibility, and denies any liability, whatsoever, to any party that uses or relies on this drawing without AECOM's express written consent. Do not scale this document. All measurements must be obtained from the stated dimensions.

AECOM
DRAFT

ISSUE/REVISION

0	15-06-2020	DRAFT ISSUE TO SDCC
I/R	DATE	DESCRIPTION

PROJECT NUMBER
 60578132

SHEET TITLE
 LETTER OF CONSENT REQUEST TO SDCC

SHEET NUMBER
 PR02491-ACM-01-00-DR-CE-10-0002

A LETTER OF CONSENT REQUEST TO SDCC
 0002 Scale: 1:500 @ A1 / 1:1000 @ A3